

INSTRUCTIONS

PAINT ALL DETAILS AND LET DRY BEFORE ASSEMBLING (SEE SECTION 8)
N.B. FOR PAINTING USE "AIRFIX" PAINTS, FOR FIXING USE "AIRFIX" POLYSTYRENE CEMENT

1

ENGINE ASSEMBLY

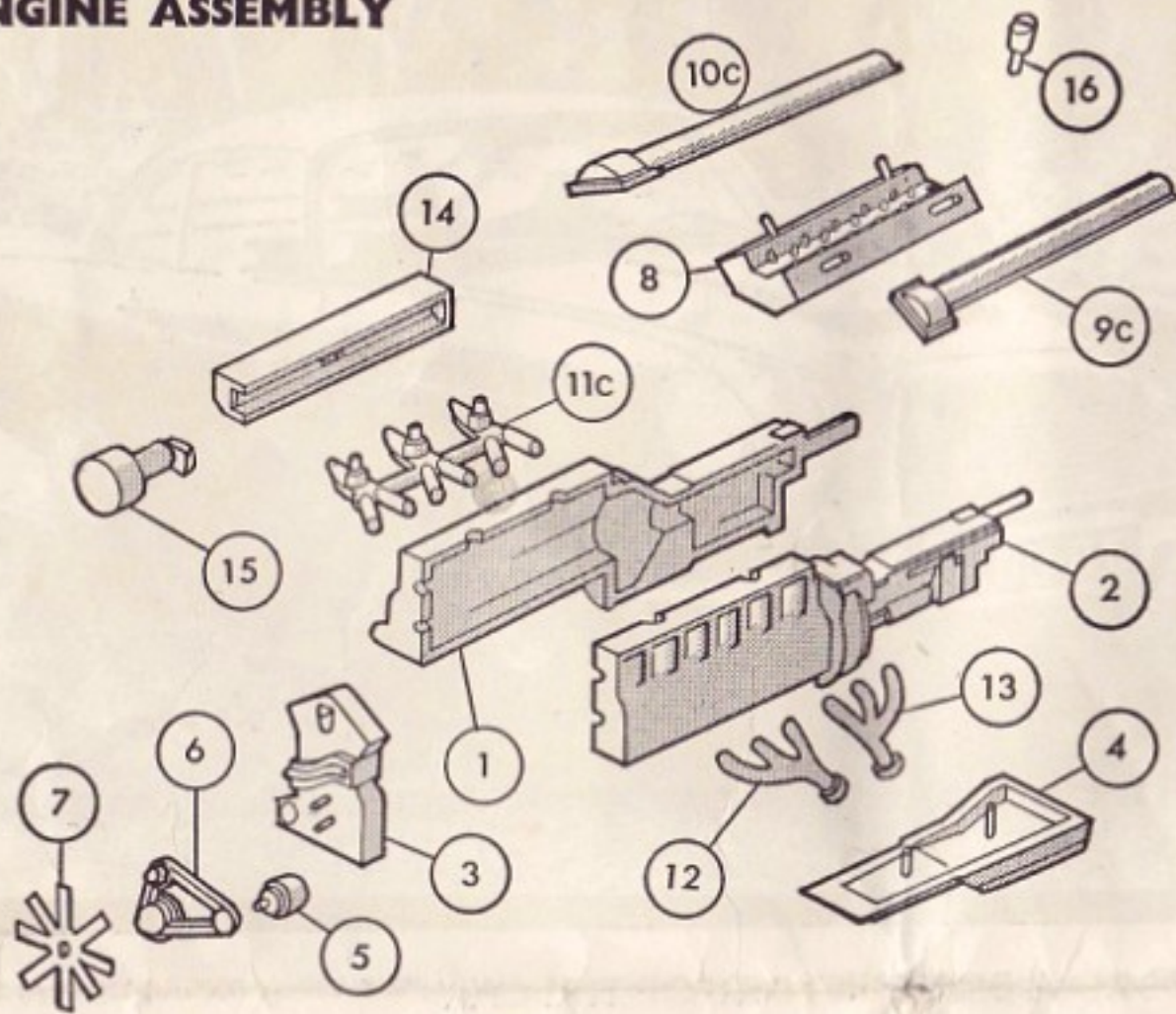

It is recommended that the instructions and exploded view are studied before assembly. Whenever possible parts should be painted before being assembled. Plating on chrome parts denoted by a letter C after the number on the instruction sheet should be carefully scraped away where cement is to be applied.

1. Locate and cement engine halves (1, 2) together.
2. Locate and cement front cover (3) to front of engine.
3. Locate and cement sump (4) to bottom of engine, wide end to rear.
4. Locate and cement locating pin on alternator (5) into locating hole in small pulley on fan belt (6). Cement fan (7) onto boss on front of fan belt, then locate and cement completed assembly to front of engine.
5. Locate and cement cylinder head (8) to top of engine.
6. Locate and cement cam boxes (9C, 10C) to top of cylinder head, wide ends to front.
7. Locate and cement triple carburettors (11C) into locating holes in right hand side of cylinder head.
8. Locate and cement exhaust manifolds (12, 13) into left hand side of cylinder head.
9. Locate and cement air distribution box (14) over projection on triple carburettors, end with cut-out forward. Cement lug on air cleaner (15) into cut-out in air distribution box. NOTE: cleaner forward and inwards towards engine.
10. Locate and cement distributor (16) into locating hole at rear end of cylinder head.

EJECTOR SEAT ASSEMBLY

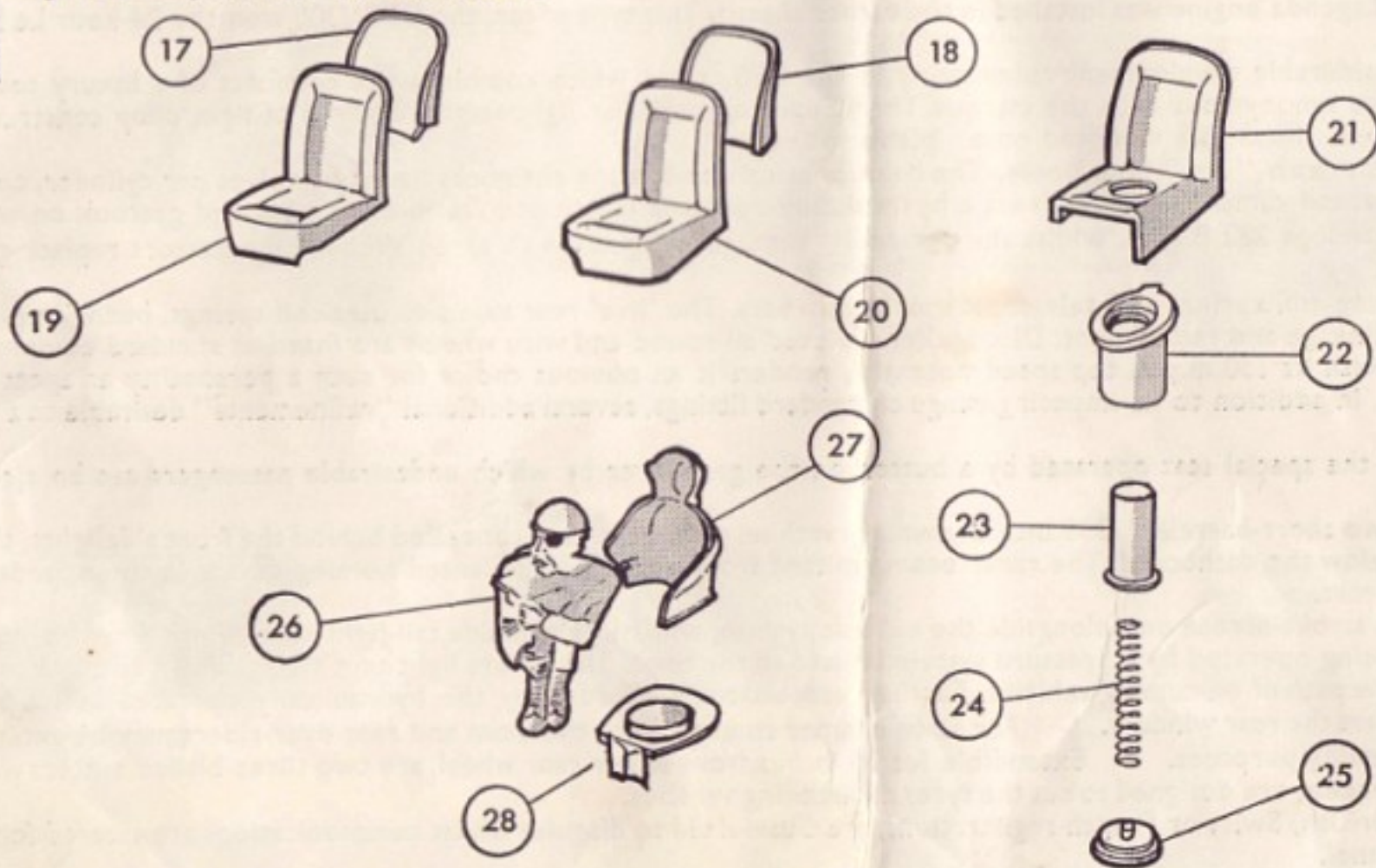

11. Standard seats (DB5):— cement seat backs (17, 18) to seats (19, 20). James Bond version:— assemble right hand driver's seat as above; for ejector seat, cement shortened seat (21) with hole in centre to left hand seat back (18).
12. Locate flange on ejection cylinder (22) into circular rib on underside of seat. NOTE: projection on cylinder flange fits cut-out in rib, then cement in position, do not allow cement to get inside cylinder or seat will not operate. Allow to dry.
13. Insert plunger (23) in cylinder, with flanged end towards open end of cylinder. Insert coil spring (24) inside plunger and locate protruding end of spring over central pip on cylinder cover (25) then cement cylinder cover in place. DO NOT allow cement to run inside cylinder or come into contact with plunger. Hold cover in place until cement has dried.
14. Cement front half of passenger (26) to rear half (27).
15. Locate and cement base of passenger (28) into open end of figure. NOTE: recessed cup faces inwards.

3

INTERIOR ASSEMBLY

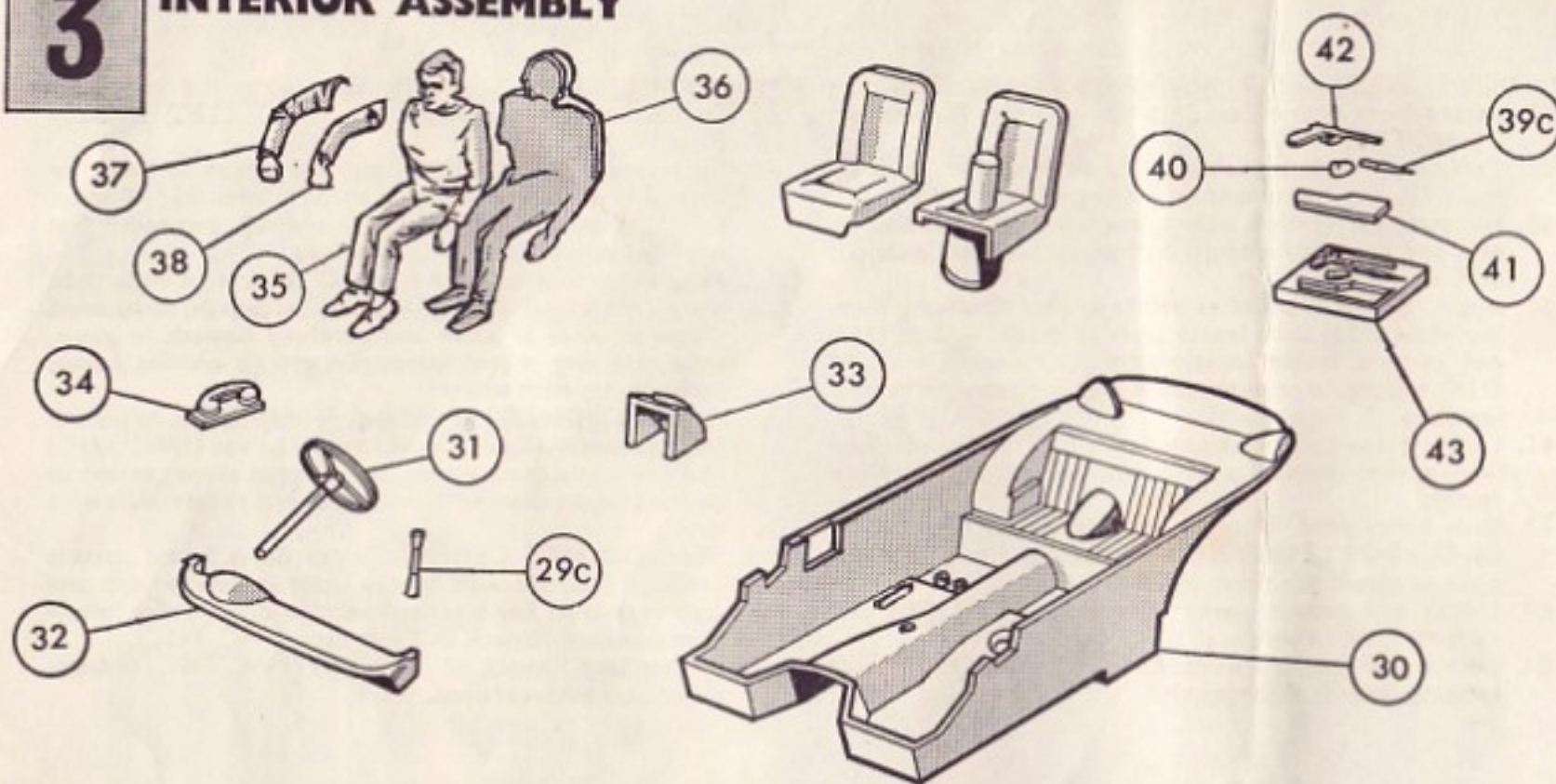

16. Cement gear lever (29C) into locating hole on transmission tunnel of interior pan (30).
17. Cement right hand driver's seat onto locations in interior pan.
18. Locate and cement steering wheel (31) into locating hole in dashboard (32) then locate and cement radar screen (33) to locations beneath dashboard.
19. Locate and cement assembled dashboard unit into cut outs in interior pan sides, lower edge of radar screen resting on transmission tunnel.
20. Cement radio telephone (34) to location on inner side of driver's door panel.
21. Cement front half of driver (35) to rear half (36), cement arm halves together (37, 38), locate and cement to driver's shoulder, before cement hardens place figure in seat and adjust arm to fit steering wheel, then cement figure in position.
22. Locate and cement armament, knife (39C), grenade (40), gun butt (41), revolver (42) into case (43) then cement tray to rear deck behind rear seat.

NOTE: For standard version, delete ejector seat, radar screen, armament and telephone and substitute standard seat in place of ejector seat. This completes interior assembly and any further interior painting desired, should now be carried out. Set aside to dry.

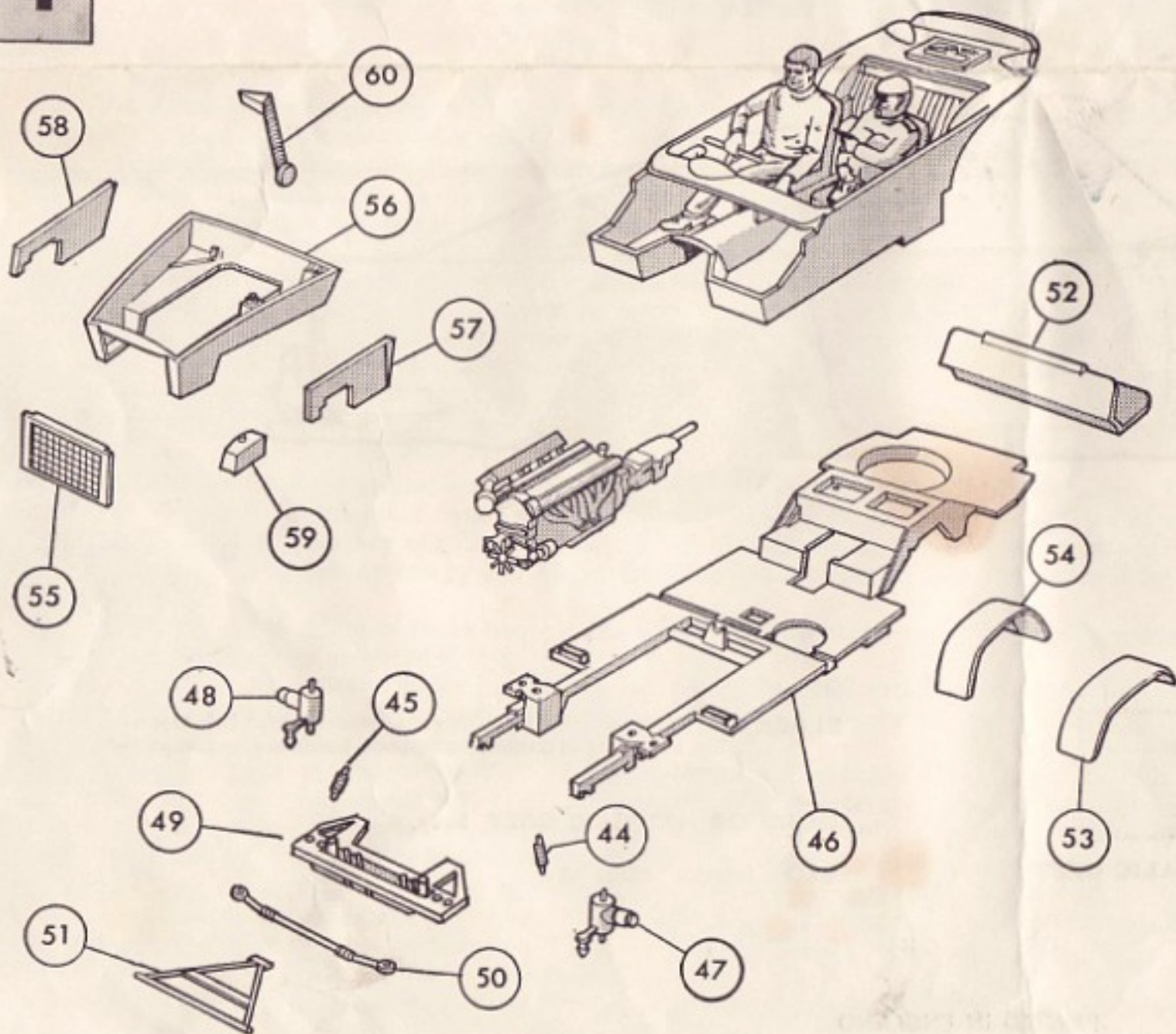

23. Locate and cement upper angled ends of front springs (44, 45) into inner holes of suspension lugs beneath chassis frame (46).
24. Locate upper pivot pins of stub axles (47, 48) into outer holes in suspension lugs. Note track rod connections face forward and downwards. Locate front cross member (49) beneath chassis frame at same time locating lower ends of springs and stub axles. NOTE: CEMENT cross member and springs, DO NOT CEMENT stub axles.
25. Spring ends of track rod (50) over pins on stub axles. DO NOT CEMENT.
26. Locate cement radiator support "A" frame (51) to locations on cross member and under chassis.
27. If modelling James Bond version only, break away thin wall to expose large hole on passenger's left hand side of chassis pan. Locate and cement completed interior assembly onto chassis locations. (Ejector seat cylinder passes through large hole.)
28. Locate and cement boot liner (52) into locations on rear of chassis.
29. Position and cement wheel arches (53, 54) onto locations at rear of chassis.
30. Locate and cement radiator (55) into front of engine compartment (56) from outside.
31. Locate and cement left (57) and right (58) compartment sidewalls, inside locating ribs on underside of engine compartment sides. NOTE: ribs at rear edge of sidewalls to outside. Cement completed assembly onto chassis frame.
32. Place assembled engine in compartment, locating step in sump over front cross member and end of gearbox into transmission tunnel, cement in place.
33. Position and cement expansion tank (59), heating ducting (60) to locations within engine compartment, ducting angled across left hand rear side of compartment.

REAR AXLE ASSEMBLY

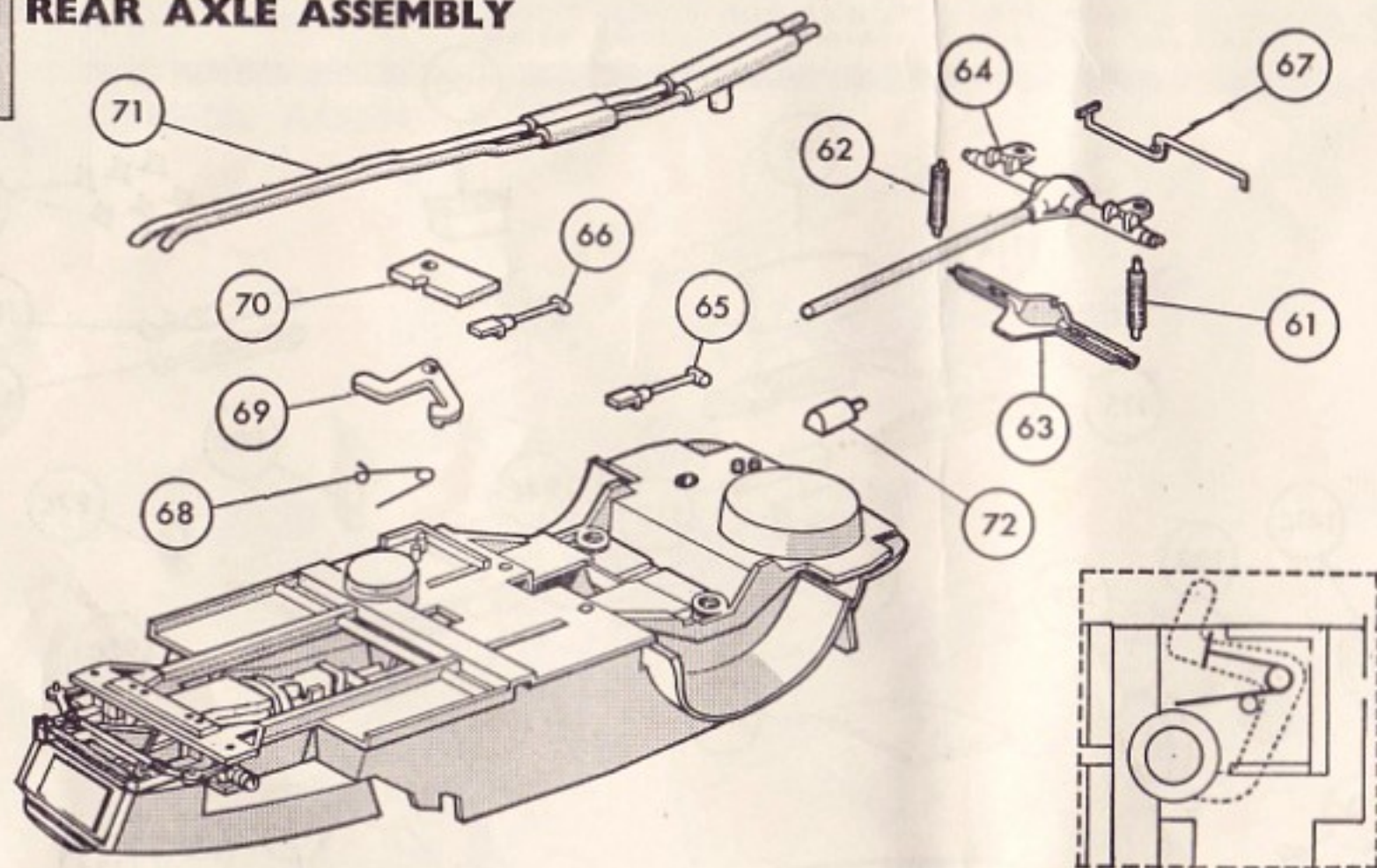

34. Locate and cement rear springs (61, 62) (straight) into recessed cups on underside of chassis pan.
35. Cement rear axle halves (63, 64) together. Slide prop-shaft end into transmission tunnel, locate axle over spring ends and cement in position.
36. Locate and cement flat ends of radius arms (65, 66) over steps beneath chassis pan and opposite ends into locations on axle.
37. Locate and cement Watts linkage (67) to rear of axle. Allow rear axle assembly to dry.
38. Slip trigger spring (68) onto large pivot pin adjacent to ejector cylinder on underside of chassis, straight arm of spring against smaller pivot pin and alongside cylinder. Slide trigger (69) onto pivot pin, engage barbed end in slot in cylinder and hook spring over arm. See inset.
39. Apply cement to raised ribs around trigger mechanism. Locate retaining plate (70) over pin and press into position. Ensure no cement comes into contact with moving parts.
NOTE: if modelling standard version, delete instructions 38 and 39 and remove pins from underside of chassis if desired.
40. Cement locating pins on exhaust pipes (71) into locating holes in chassis and ends to exhaust manifolds.
For James Bond version, cut exhaust pipes at "vee" lines then cement separate parts to appropriate locations, to clear ejection mechanism.
41. Cement smoke unit (72) to locations on rear and underside of chassis, alongside exhaust pipes.

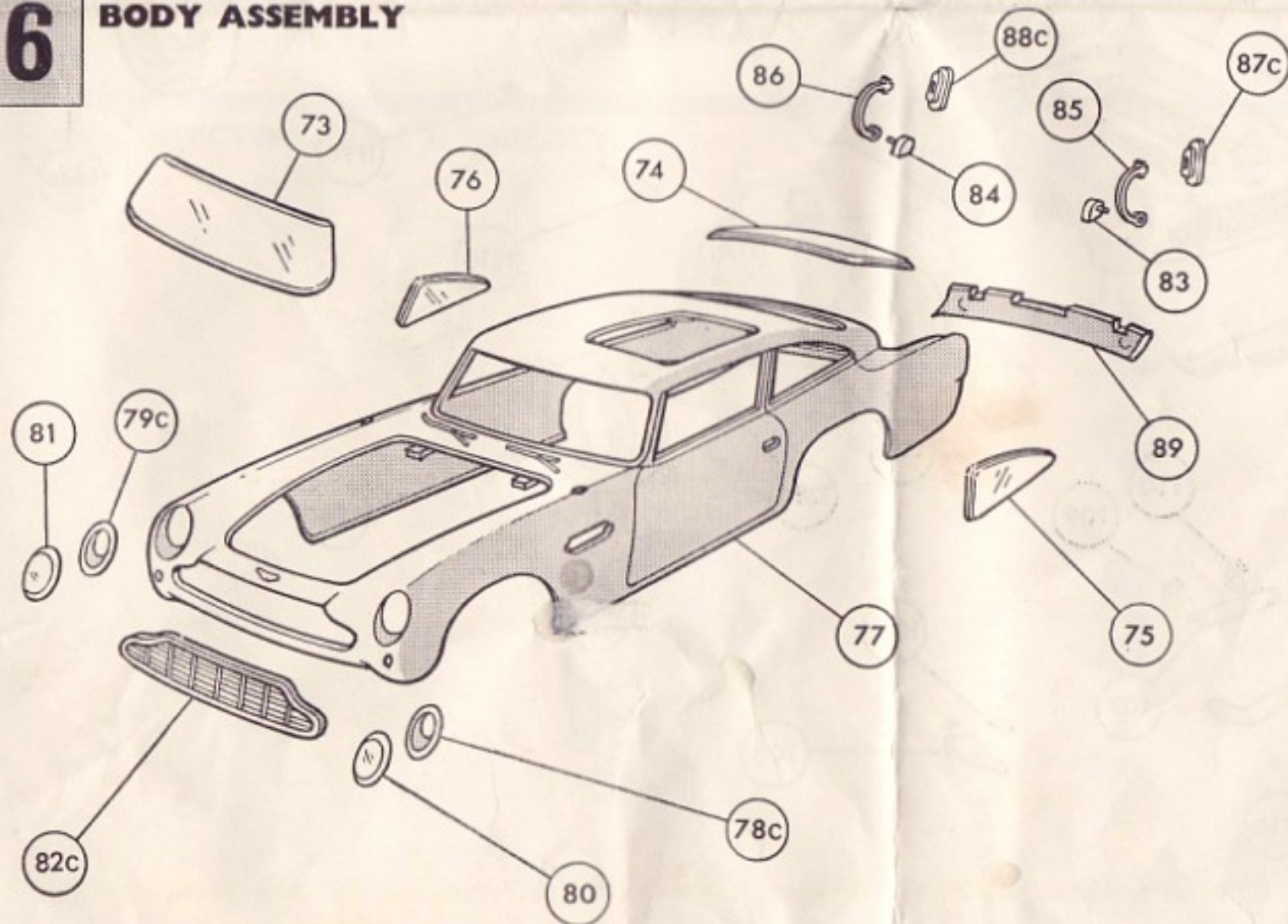

42. Carefully cement transparencies, windscreen (73), rear window (74), side windows (75, 76) to body shell (77) from inside.
43. Insert and cement headlamp shells (78C, 79C) into apertures in front of wings. Carefully cement headlamp lense transparencies (80, 81) to headlamp shells, use cement sparingly or lenses will fog.
44. Locate and cement radiator grille (82C) into front of body.
45. Insert pins of rear light pivots (83, 84) through eyes of curved arms (85, 86). Very carefully cement large end of pivots to rear face of body against ribs. NOTE: pins face towards body shell. Ensure no cement comes into contact with working hinges.
46. Cement rear lights (87C, 88C) to ends of arms and check for correct location and movement. Allow to dry. NOTE: for standard version delete instruction 45 and cement rear lights to rear of body.
47. Locate and cement rear roll pan (89) to rear of body.
48. Insert completed chassis into body shell. It is advisable to assemble this unit dry, and check for successful passenger ejection; adjustments, if required, being made before finally cementing in place.

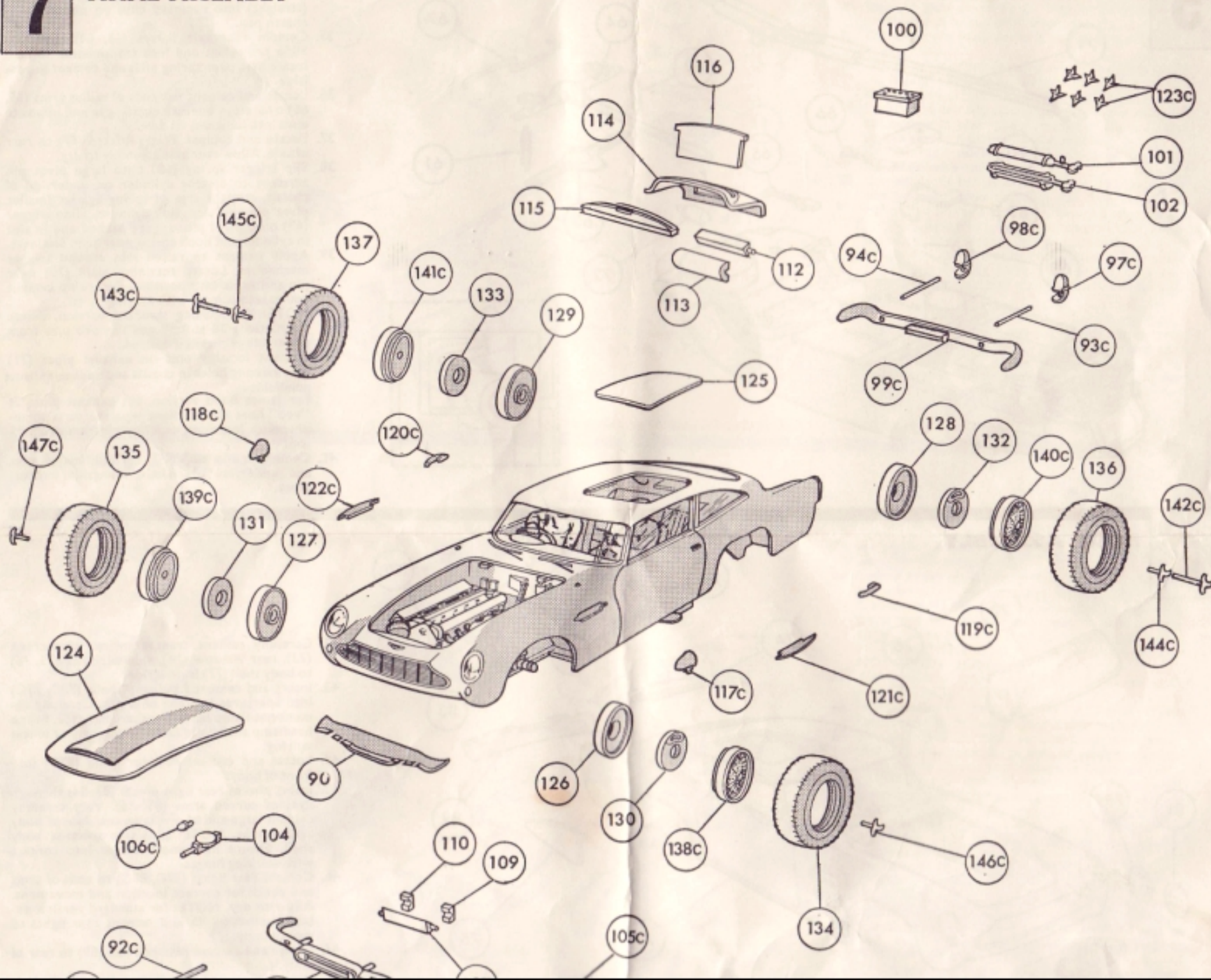

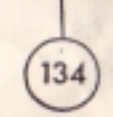
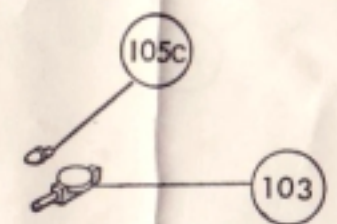
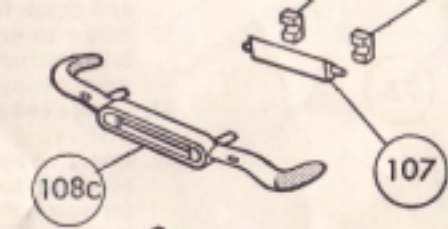
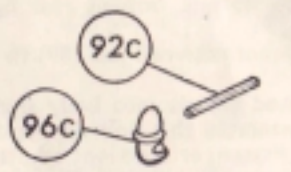

FINAL ASSEMBLY

49. Locate and cement front roll pan (90) to front of body.
50. Cement the square over-rider pillars (91C-94C) into rear of over-riders (95C-98C). Allow to dry thoroughly.
51. Locate and cement rear bumper (99C) (with over-riders positioned) into locations on rear of body, do not get cement on movable over-riders.
52. Cement battery (100) to raised locations on right hand side of boot liner floor.
53. Cement air cylinder halves (101, 102) together, then cement to locations on boot liner.
54. From inside insert James Bond machine guns (103, 104) through sidelamp apertures on front of body, cement in position. For standard version omit guns and cement sidelamps (105C, 106C) into apertures from outside.
55. Dip number plate transfer in warm water for a few minutes, slide off backing onto revolving front number plate (107). Allow to dry.
56. From rear, insert plate into central opening in James Bond bumper (108C). Locate number plate retaining blocks (109, 110) over pins on plate and cement to rear of bumper, ensuring no cement comes into contact with revolving plate.
57. Locate front over-riders into square holes in bumper. **DO NOT CEMENT.**
58. Cement front bumper assembly to locations on body front. Do not get cement on moving parts.
59. For standard version delete instructions 55-58 and locate and cement standard bumper (111C) to locations on front of body.
60. Apply number transfer as before to rear revolving number plate (112) then locate plate in retaining box (113) and cement inside locations in aperture of boot lid (114). Ensure no cement comes into contact with revolving plate.
61. Locate guide for bullet-proof shield (115) against locations against slot on inside of boot lid. Cement and allow to dry.
62. Slide bullet-proof shield (116) into slot at top of boot lid, **DO NOT CEMENT.** Boot lid may be fitted in either open or closed positions or left loose.
63. Locate and cement wing mirrors (117C, 118C) into locating holes in wings.
64. Locate and cement door handles (119C, 120C) into locating holes in door panels.
65. Locate and cement side trims (121C, 122C) to body sides.
66. Commando Spikes (123C) may be placed in boot, or spread in road behind car if suitably mounted. Bonnet lid (124) and roof panel (125) are not cemented but merely fitted in respective positions.
67. Place inner wheel halves (126-129) over axle ends, then place brake discs (130-133) detail outwards, onto small diameter ends of axles and carefully cement in place, thus retaining wheel halves. Ensure no cement comes into contact with wheels.
68. Fit tyres (134-137) onto inner wheel halves, apply cement to outer edges of outer wheel halves (138C-141C) and press into place inside tyre. Do not allow cement to contact brake discs or wheels will not rotate. Allow to dry.
69. Slide, **DO NOT CEMENT,** James Bond wheel cutters (142C, 143C) through centre holes in rear wheels and into rear axle. For standard version discard and substitute standard "knock off" hub caps (144C, 145C).
70. Fit standard "knock off" hub caps (146C, 147C) to front wheels on both versions.